

# 1 皇冠安装

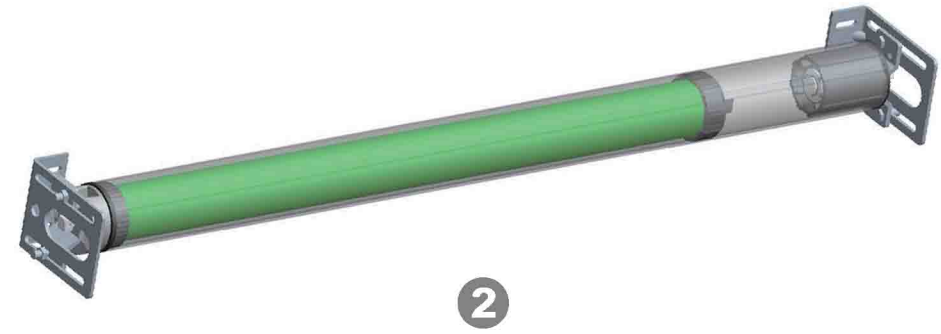

# 2 转轮安装

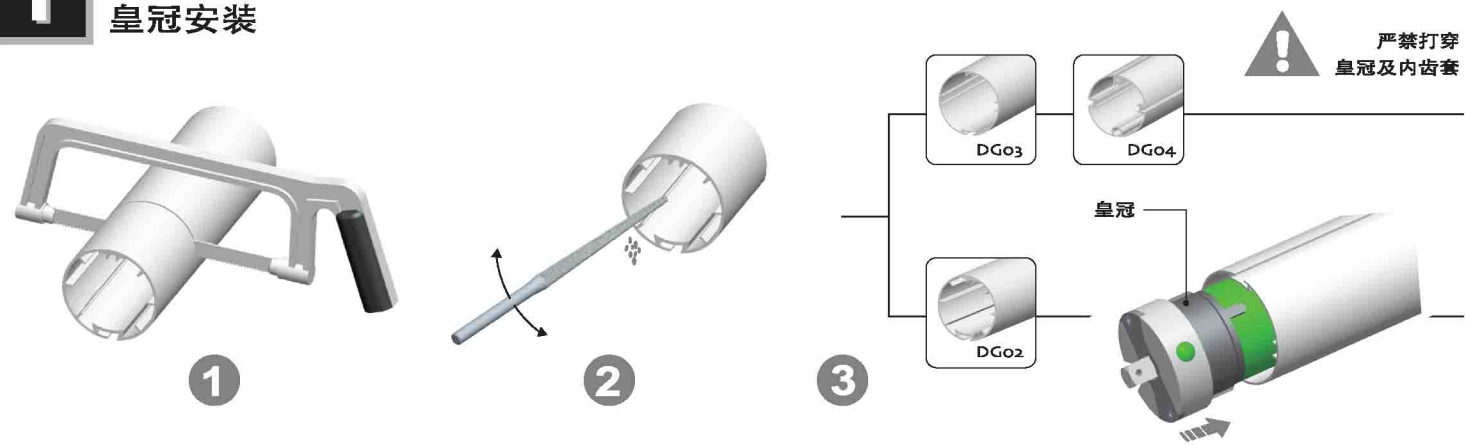
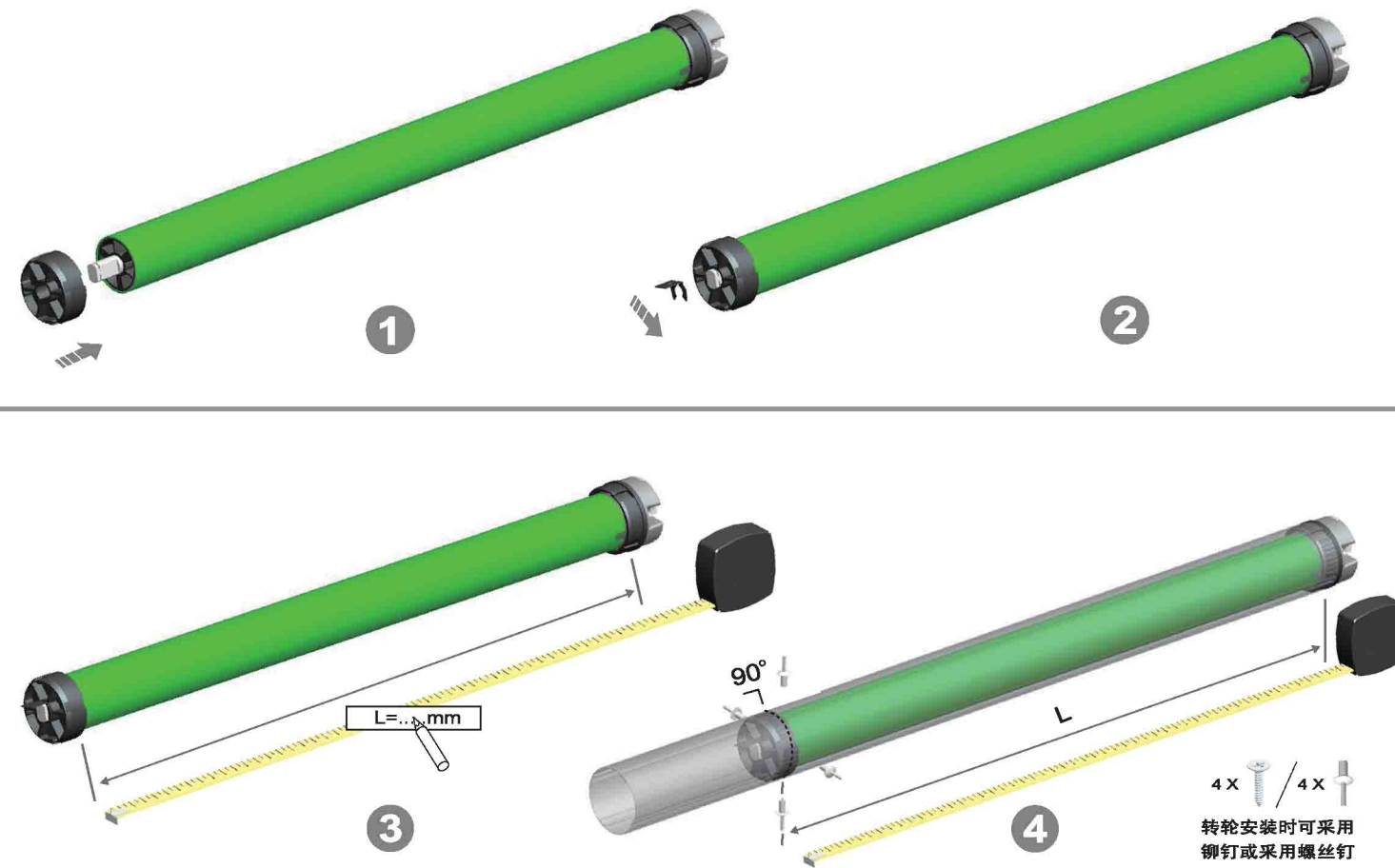

# 3 支架安装

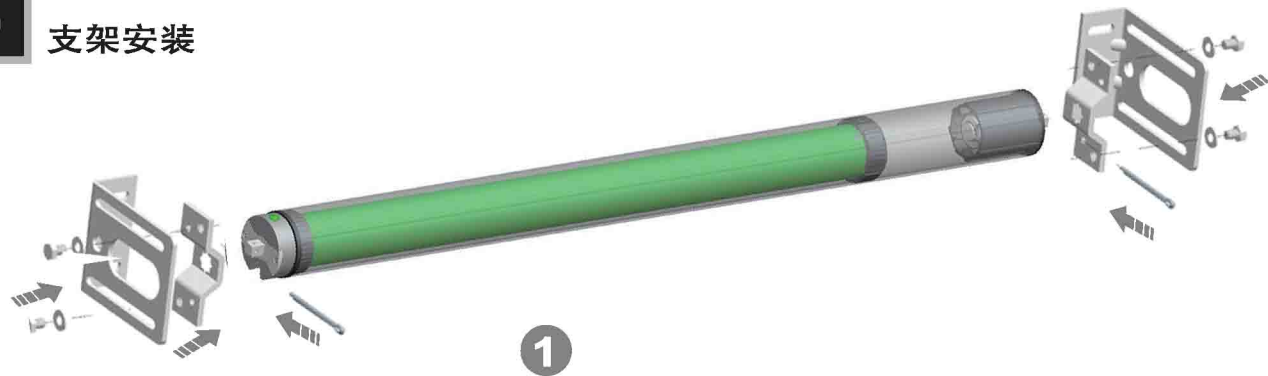

# 附

## 顺转行程设定

附加功能

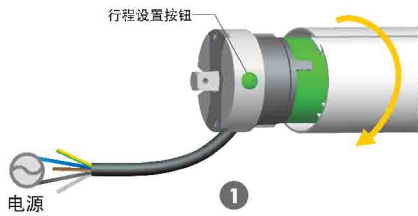

黑线和蓝线接电源时，转轮顺转

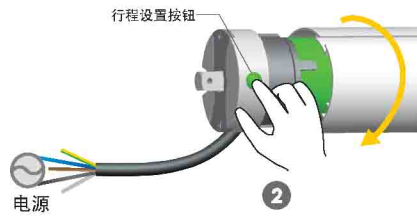

转轮顺转或者停止时(黑线和蓝线接电源)用手按住行程头上面的设置键，电机顺转

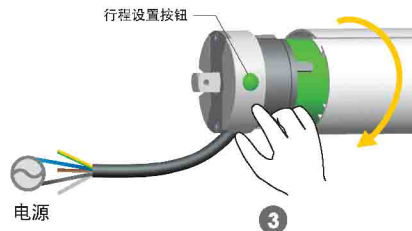

松开行程头上面的设置键即确认顺转行程点

重复 2 3 步骤即可准确设定顺转行程点

# 附

## 逆转行程设定

附加功能



棕线和蓝线接电源，转轮逆转

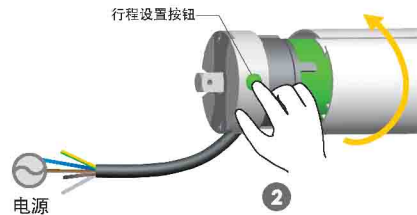

转轮逆转或者停止时(棕线和蓝线接电源)用手按住行程头上面的设置键，电机逆转

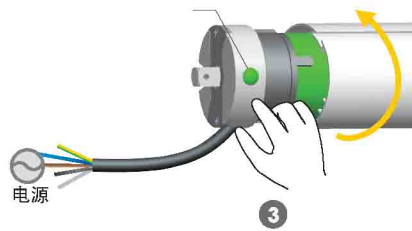

松开行程头上面的设置键即确认逆转行程点

重复 2 3 步骤即可准确设定逆转行程点



所有控制器都分别有 230V/50Hz & 120V/60Hz @ 110V/60Hz  
具体参数以铭牌为准



**B: Button Electronic / 按钮电子型**  
电子行程限位 + 遇阻停止功能  
Electronic Limit +  
Resistance and stop function



## B/BK 型管状马达产品说明书

版本: A/05

### 技

#### 设定行程限位方法

1 设定行程限位方法

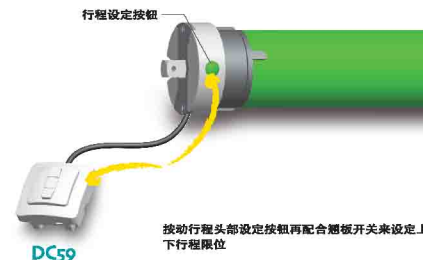

单相翘板开关(机械式)

2 设定行程限位方法

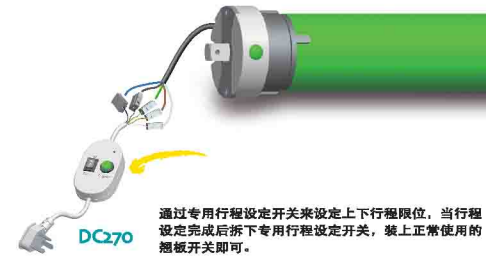

### 技

#### 接线图

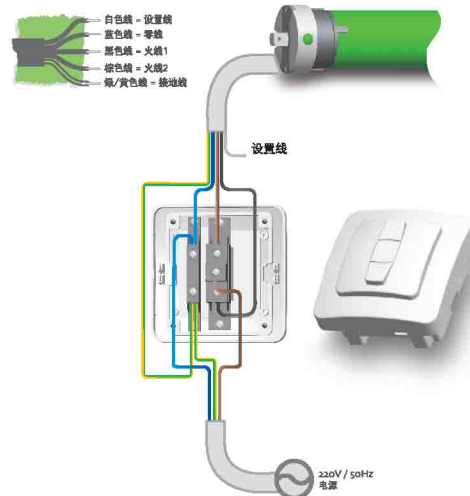

#### 注意事项

客户请将多余的接线，进行隔离，可使用配件包内的压线帽(或者使用其他方式)

